

# 4" LED Recessed Round Gimbal WIFI SMART



## Product Description

- 1.Cell-phone Control: Open the remote control APP, enjoy a new lifestyle instead of "Getting up to turn off lights"or "forget to turn off lights".
- 2.Voice Control: The product is supported by mainstream smart home platforms,such as Amazon Echo, Google Home, IFTTT, Tmall ELF, Google Nest, etc. Just say the specfic commands to the smart speakers, the app will respond and control lighting selections accordingly.
- 3.Functions: On/off, timing, colors choose, brightness adjustment, mode selection, color switching, music sync and so on.
- 4.Wireless module connection, safe and reliable, ultra low power consumption.
- 5.Built-in global cloud service, extremely reliable system deployment architecture, uninterrupted continuous service time 99.99%.
- 6.Top level information security, ISO 27001 information security management system certification.



## Applications

Enhanced APP Dimmer Control Capabilities :  
This light can smoothly dim from 0% - 100% without flickers or noises by APP Dimmer, making it ideal for bathrooms, kitchens, living rooms, entry ways, attics, hallways, etc



## Specification

|                          | Input Power | Lumen Output | Equiv | Size         | Power Factor | CCT             |
|--------------------------|-------------|--------------|-------|--------------|--------------|-----------------|
| <b>ELSDW1004WE1WH-12</b> | 12W         | 850lm        | 85W   | 4"           | >0.9         | RGB+2700K~6500K |
| Input Voltage            | Dimmable    | Beam Angle   | CRI   | Application  | Materials    | Lifespan        |
| AC120V/60Hz              | Yes         | 40degree     | >80Ra | Wet Location | Aluminum     | 50,000 Hours    |

## Product Dimensions

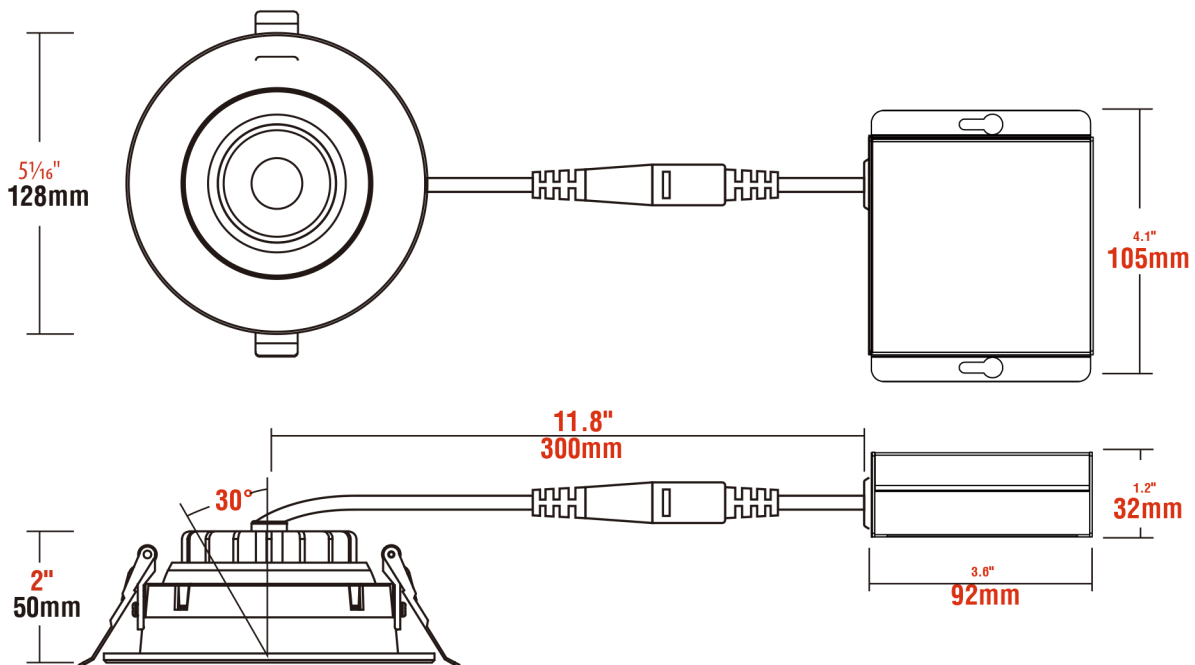

# 4" LED Recessed Round Gimbal WIFI SMART



## Product Structure



## Product Operation

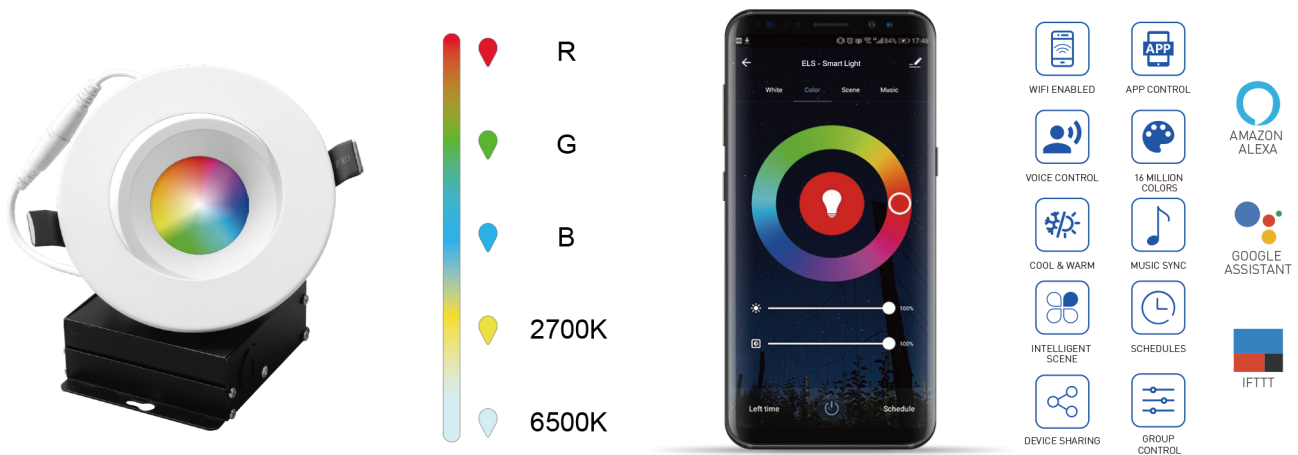

## Download And Install APP



\*Use your phone to scan the QR code above or search "Smart Life" in application market to download and install the App

*\*This App is compatible with mobile devices IOS 8.0 and above and Android 4.0 and above.*

*For more details, please ask our sales person for user manual.*



"Alexa..."



"OK Google..."

## Installation



Find out the template (for the hole size installation) back of the box. Use the circle template to measure the size of holes. Then cut out holes.

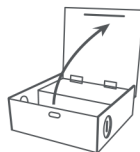

Open the box.  
Take out accessory of wire clip.

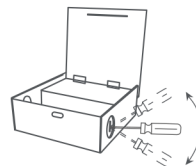

Use suitable tool to remove one of the knockouts of the side plate.

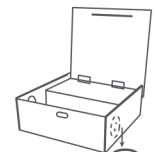

Remove one of the knockouts on the side plate.  
Put wires through the hole.

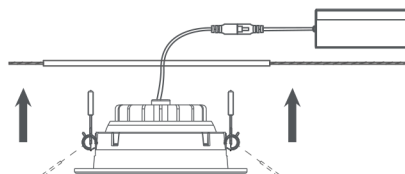
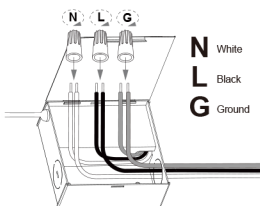

Holdin g the clips, and push the fixture into installation hole.

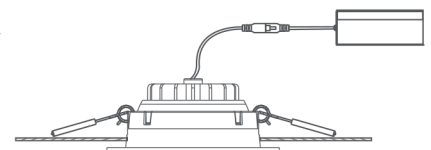

Release spring clips and push into place.