

4" SLIM LED RECESSED DOWNLIGHT 5 COLORS IN 1

Product Description

Reliable Quality: This IC rated downlight is permitted to be in contact with combustible material and is Energy Star and ETL certified for energy conservation and safe operation.

Space-saving Design: This slim recessed ceiling light is an optimum choice for your narrow ceiling that doesn't need a can.

Long-lasting Illumination: This light is an ideal replacement for incandescent light with providing high brightness, which can largely reduce the replacement and maintenance frequency.

Simple Installation: Easy installation steps make you finish the installation in a flash and recessed can is no longer a limitation for your choice. Connect and fix the wires, and then use spring clips to fix it on the ceiling.

Color Changing Function: 5CCT Selectable by dip switch or wall switch.

Applications

This light can smoothly dim from 10% - 100% without flickers or noises and is compatible with most LED dimmers, making it ideal for bathrooms, kitchens, living rooms, entry ways, hallways, etc



Specification

	Input Power	Lumen Output	Equiv	Size	Power Factor	CCT
ELSDR1604G55WH-08	8W	850lm	75W	4"	>0.9	2700K/3000K/3500K 4000K/5000K
Input Voltage	Dimmable	Beam Angle	CRI	Application	Materials	Lifespan
AC120V/60Hz	Yes	120degree	>90Ra	Wet Location	Aluminum	50,000 Hours

Product Dimensions

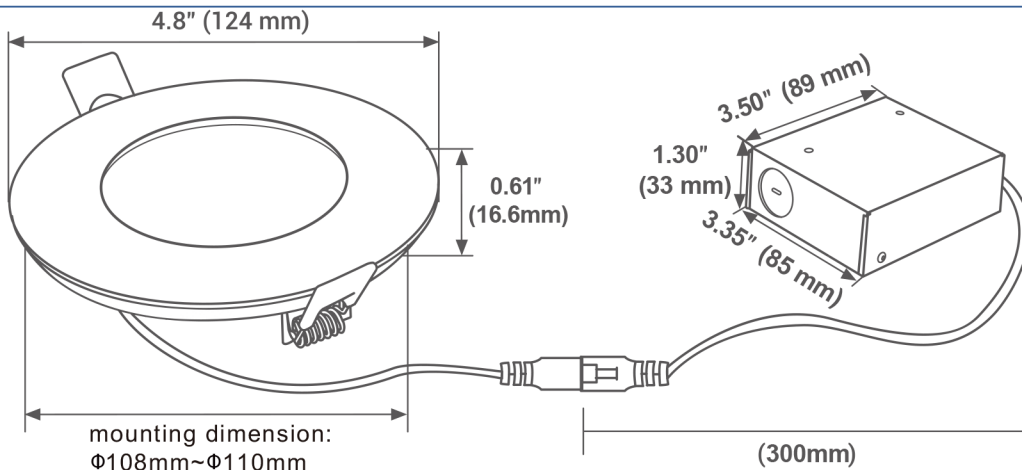

4" SLIM LED RECESSED DOWNLIGHT 5 COLORS IN 1

Product Structure

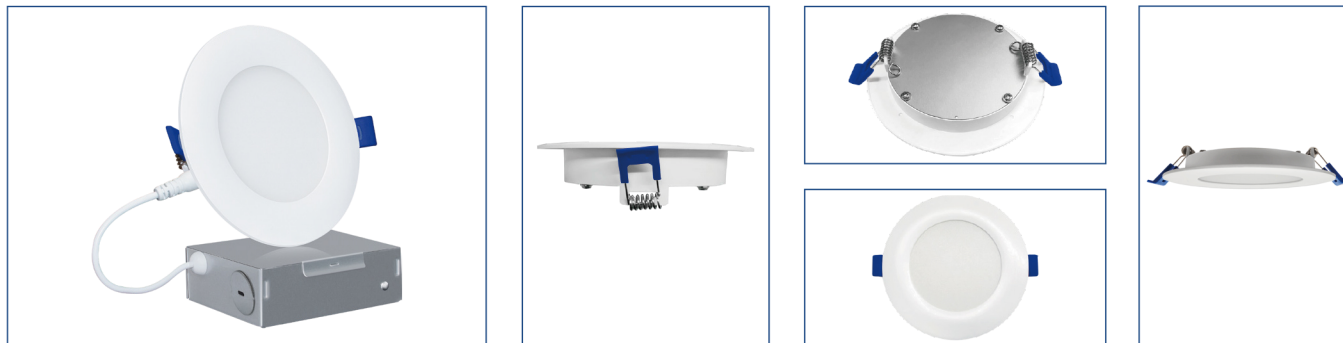

Product Operation

There is dip switch on the front of driver box, and regularly marks 2700K/3000K/3500K/4000K/5000K/SW, the dip switch also called CCT select-able.

1. By dip switch

Select certain color temperature (2700K/3000K/3500K/4000K/5000K) on dip switch, then the light will be that color. Wall switch only has ON/OFF function under this situation.

2. By wall switch

Select "SW" on the dip switch firstly, then turn on the wall switch, the default first ON CCT is 5000K, then "ON-OFF-ON" the wall switch in 2S, the CCT will be 2700K/3000K/3500K/4000K/5000K in orderly. After "ON-OFF-ON" is continuous for 8 times, the CCT of the lamp will stay at 2700K, no longer changing. If you need to change the CCT again, turn OFF the lamp and ON again after 6s to restart the CCT changing function.

If light is off longer than 6-8S, it has memory function and CCT keeps same as last time when you turn it on.



Installation



Find out the template(for the hole size installation)back of the box,Use the circle template to measure the size of holes Then cut out holes.

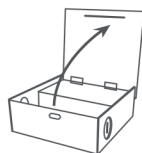

Open the box.
Take out accessory of wire clip.

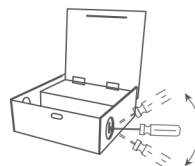

Use suitable tool to remove one of the knockouts of the side plate.

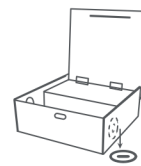

Remove one of the knockouts on the side plate.
Put wires through the hole.

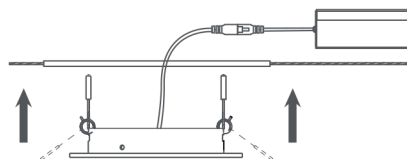
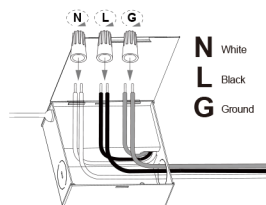

Holdin g the clips, and push the fixture into installation hole.

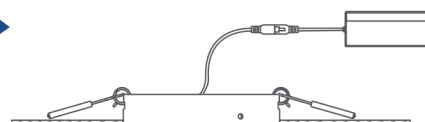

Release spring clips and push into place.